

E10 series/ Scara Robot

Model E10-551S

Operating range Arm length 550mm Joint#3 stroke 100mm

Payload Rated 5kg/Maximum 10kg

Standard cycle time 0.42 sec

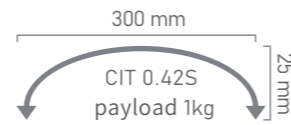

Cycle time based on round-trip arch motion (300mm horizontal, 25mm vertical) with 2kg payload (path coordinates optimized for maximum speed)

Repeatability $\pm 0.025\text{mm}$ $\pm 0.01\text{mm}$ $\pm 0.01^\circ$
Joint #1,#2 Joint #3 Joint #4

Parameters of each axis

Joint Content	#1	#2	#3	#4
MAX Operating Speed	7500 mm/s		1100 mm/s	2600°/s
MAX Motion Range	$\pm 225^\circ$	$\pm 225^\circ$	100mm	$\pm 720^\circ$
Motor Power Consumption	1000W	750W	400W	400W
Joint#3 down force			250N	
Weight	40kg (cables not included)			

Joint #4 allowable moment of inertia, rate $0.005\text{kg}\cdot\text{m}^2$, maximum $0.05\text{kg}\cdot\text{m}^2$

Electrical parameters	Origin Return	None Need Origin Return
Installed wire for customer	15Pin (D-Sub Connector)	
Installed pneumatic tube for customer use	$\phi 4\text{mm}\times 1$, $\phi 6\text{mm}\times 2$	
Visual Interface	-	
Installation Environment	Stander/Clean (Customized)	

Outer Dimensions and Motion Range

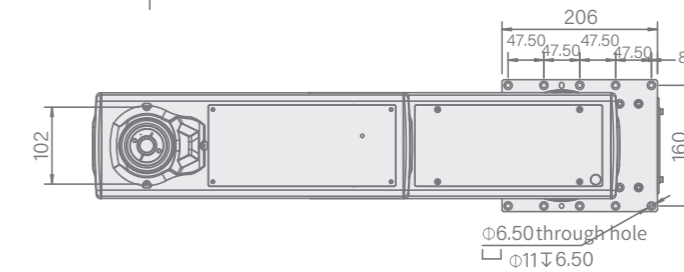
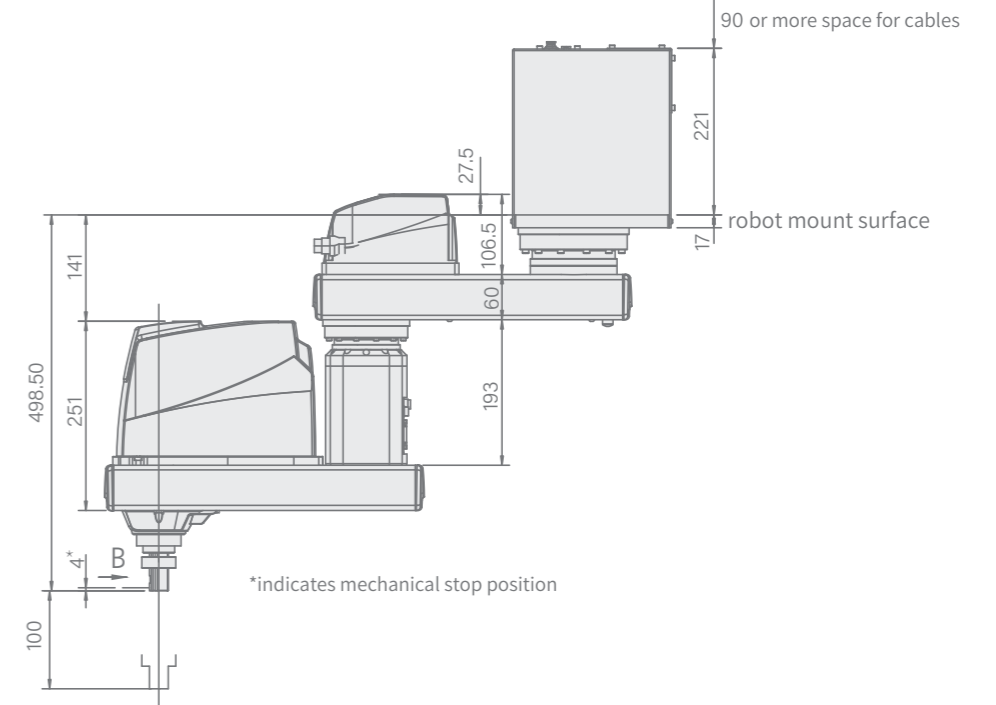
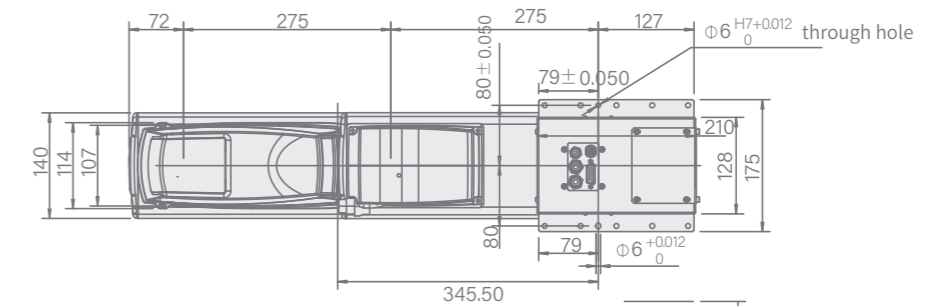

View B

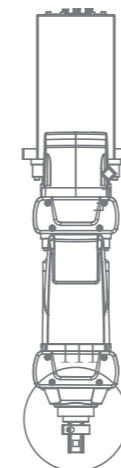

III
1:5

